

4_91_228 MAE BR33 [pg 2]

4_91_228 MAE BS32 [pg 3]

EVERSOURCE ENERGY GIS

PROPRIETARY INFORMATION: The material contained on the Overhead Distribution Circuit Map shall be considered proprietary to Eversource Energy, and Users (which shall be defined as any person or entity who has received the Map through sale, purchase, exchange gift, or otherwise) shall keep it in confidence and shall not furnish or disclose it to any third party without the prior written permission of Eversource Energy.

- | | | | | |
|-------------|---------------|-------------------|-------------------|-----------------|
| Cutout | Open Point | OH Primary | UG Primary | Streets |
| Pole | Stepdown Bank | OH Backbone | UG Backbone | Substation |
| Recloser | Tiepoint | OH Lateral | UG Lateral | Town Boundaries |
| Switch Bank | | | | |



Circuit Mileage

Backbone	3.67
Lateral	5.57
Total	9.23



Page:
1 of 5

4_91_228 MAE BR32

Circuit: 4_91_228
Towns: TIS
District: MV

Plotted:
6/15/2020



4_91_228 MAE BR32 [pg 1]

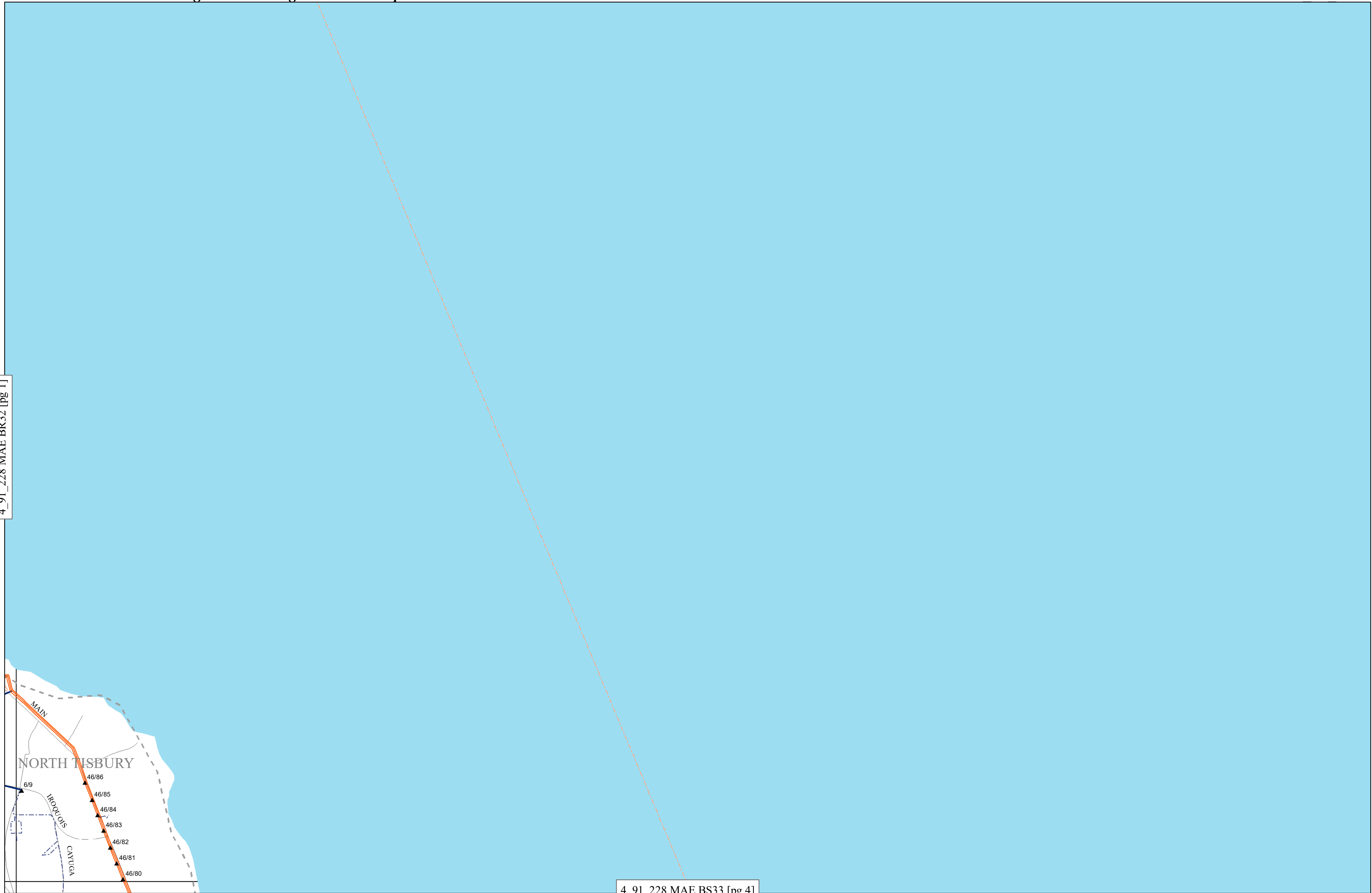

4_91_228 MAE BS33 [pg 4]

EVERSOURCE ENERGY GIS

PROPRIETARY INFORMATION: The material contained on the Overhead Distribution Circuit Map shall be considered proprietary to Eversource Energy, and Users (which shall be defined as any person or entity who has received the Map through sale, purchase, exchange gift, or otherwise) shall keep it in confidence and shall not furnish or disclose it to any third party without the prior written permission of Eversource Energy.

- | | | | | |
|-------------|---------------|-------------------|-------------------|-----------------|
| Cutout | Open Point | OH Primary | UG Primary | Streets |
| Pole | Stepdown Bank | OH Backbone | UG Backbone | Substation |
| Recloser | Tiepoint | OH Lateral | UG Lateral | Town Boundaries |
| Switch Bank | | | | |



Circuit Mileage

Backbone	3.67
Lateral	5.57
Total	9.23

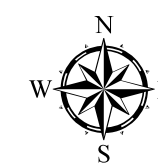

4_91_228 MAE BR33

Circuit: 4_91_228
Towns: TIS
District: MV

Plotted:
6/15/2020



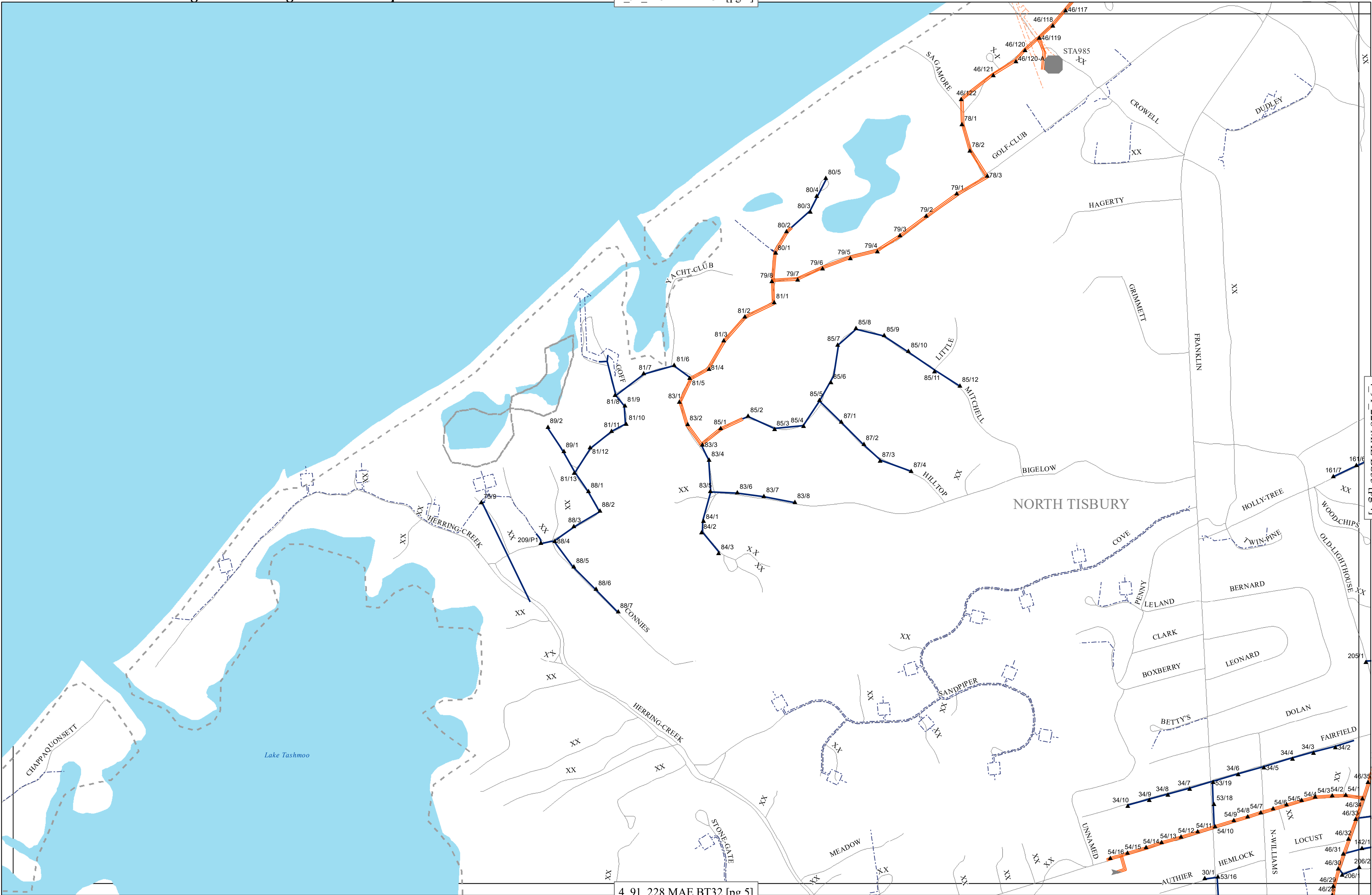

EVERSOURCE ENERGY GIS

PROPRIETARY INFORMATION: The material contained on the Overhead Distribution Circuit Map shall be considered proprietary to Eversource Energy, and Users (which shall be defined as any person or entity who has received the Map through sale, purchase, exchange gift, or otherwise) shall keep it in confidence and shall not furnish or disclose it to any third party without the prior written permission of Eversource Energy.

- Cutout
- Pole
- Recloser
- Switch Bank
- Open Point
- Stepdown Bank
- Tiepoint
- OH Primary**
- OH Backbone
- OH Lateral
- UG Primary**
- UG Backbone
- UG Lateral
- Streets
- Substation
- Town Boundaries



Circuit Mileage

Backbone	3.67
Lateral	5.57
Total	9.23



Page:
3 of 5

4_91_228 MAE BS32

Circuit: 4_91_228
Towns: TIS
District: MV

Plotted:
6/15/2020





4_91_228 MAE BS32 [pg 3]

EVERSOURCE ENERGY GIS

PROPRIETARY INFORMATION: The material contained on the Overhead Distribution Circuit Map shall be considered proprietary to Eversource Energy, and Users (which shall be defined as any person or entity who has received the Map through sale, purchase, exchange gift, or otherwise) shall keep it in confidence and shall not furnish or disclose it to any third party without the prior written permission of Eversource Energy.

- Cutout
- ▲ Pole
- ⊠ Recloser
- Switch Bank
- || Open Point
- △ Stepdown Bank
- ▶ Tiepoint
- OH Primary**
- OH Backbone
- OH Lateral
- UG Primary**
- - - UG Backbone
- - - UG Lateral
- Streets
- Substation
- - - Town Boundaries

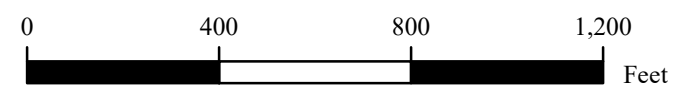

1 inch = 400 feet

Circuit Mileage

Backbone	3.67
Lateral	5.57
Total	9.23

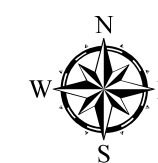

Page:
4 of 5

4_91_228 MAE BS33

Circuit: 4_91_228
Towns: TIS
District: MV

Plotted:
6/15/2020



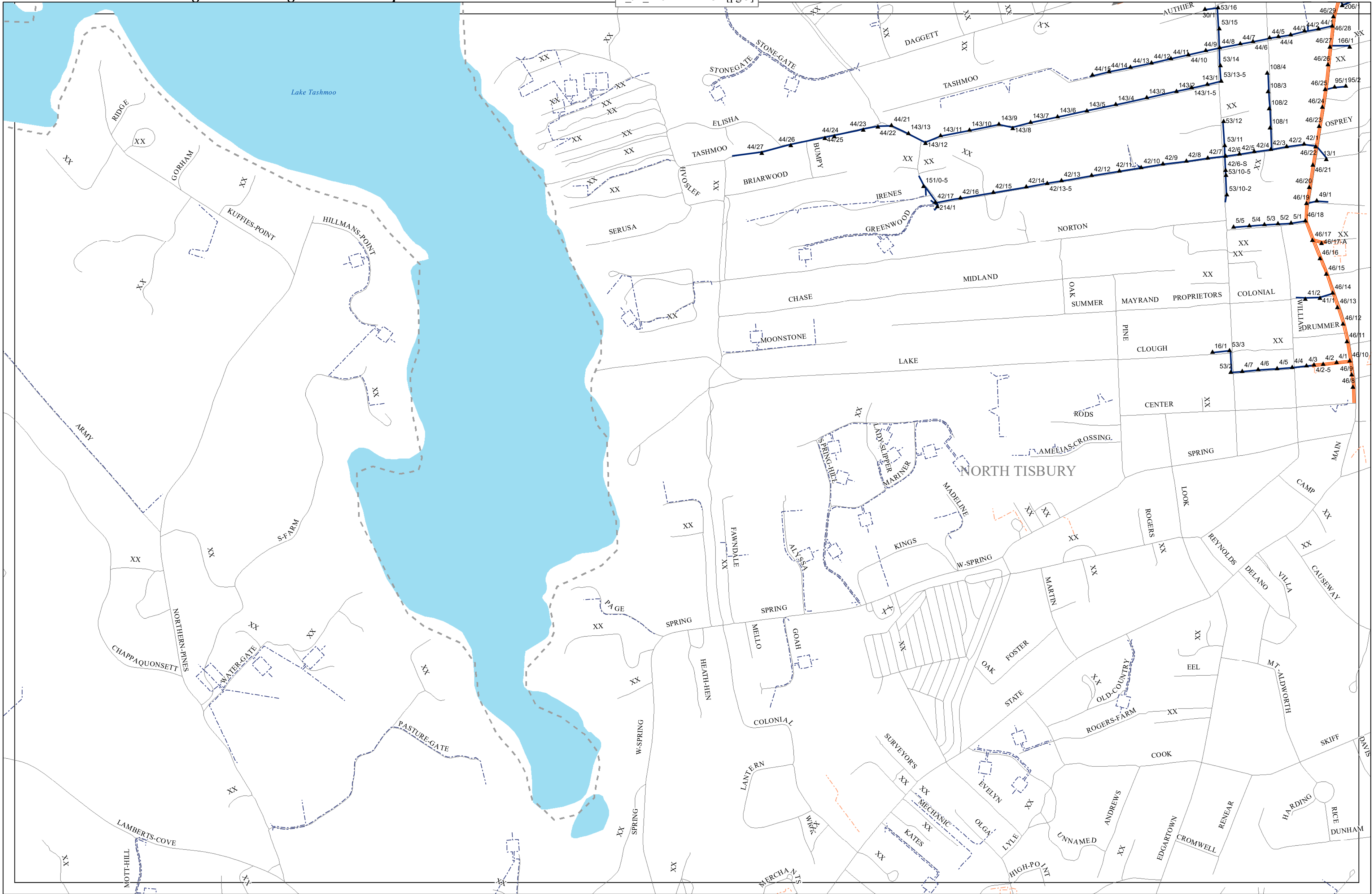

EVERSOURCE ENERGY GIS

PROPRIETARY INFORMATION: The material contained on the Overhead Distribution Circuit Map shall be considered proprietary to Eversource Energy, and Users (which shall be defined as any person or entity who has received the Map through sale, purchase, exchange gift, or otherwise) shall keep it in confidence and shall not furnish or disclose it to any third party without the prior written permission of Eversource Energy.

- Cutout
- Pole
- Recloser
- Switch Bank
- Open Point
- Stepdown Bank
- Tiepoint
- OH Primary**
- OH Backbone
- OH Lateral
- UG Primary**
- UG Backbone
- UG Lateral
- Streets
- Substation
- Town Boundaries



Circuit Mileage

Backbone	3.67
Lateral	5.57
Total	9.23

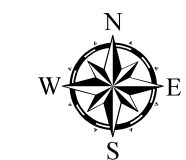

Page:
5 of 5

4_91_228 MAE BT32

Circuit: 4_91_228
Towns: TIS
District: MV

Plotted:
6/15/2020

